

Take on the role of a trainee Queensland Police Scenes of Crime Officer (SOCO)

Download the QPM Forensics AR APP from the

Google Play Store

<https://play.google.com/store/apps/details?id=com.immerseenterprise.gpsforensics>

OR

Apple Play Store

<https://apps.apple.com/au/app/qpm-forensics-ar/id1509533899>

Take the time to read the USER GUIDE

These 9 tips will help you navigate
the app successfully.

Museum staff are on hand to give
assistance if required.

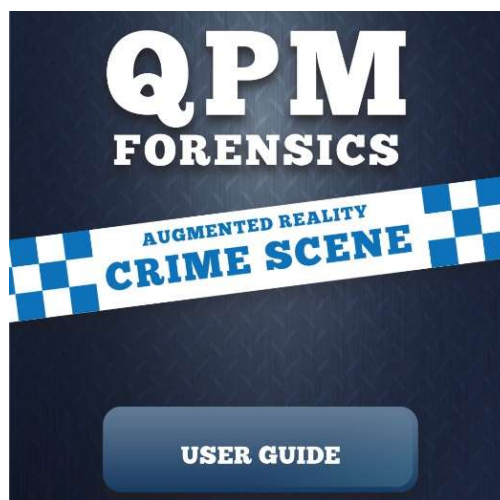

OBJECTIVE: You are a trainee Queensland Police Scenes of Crime Officer (SOCO). You have entered the scene of a murder and it is your job to use the tools at your disposal to gather evidence, compile a report, and discover who committed the crime. Take your time and read the **USER GUIDE**. Think carefully about the crime scene, the evidence presented and the ways in which you can collect it. Good photographs and careful thought about what you collect and how you have it analysed will earn you more points. The higher your score, the more likely you will pass the test and become a qualified SOCO.



Begin collecting evidence by locating the **AR Crime Scene Markers**. Scan a marker to reveal the evidence.

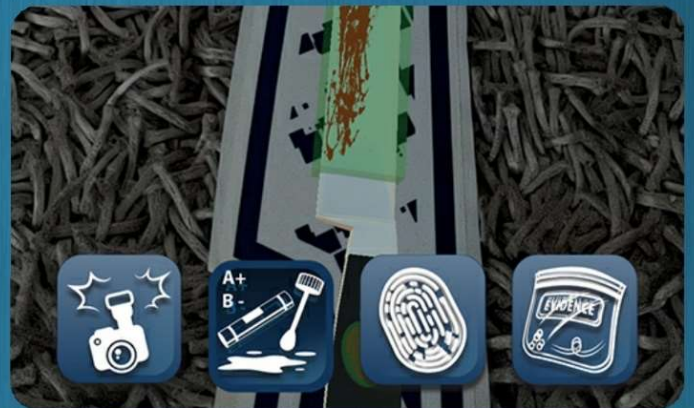

In this view you will be finding and collecting evidence. The first step is finding a marker and scanning it with your device. An aspect of the crime scene will be revealed, and you will use the app's unique tools to collect evidence.

The **order of icons** reflects the order in which SOCO's treat true crime evidence.



Your main methods of evidence collection are DNA swabs , latent fingerprint impressions , and bags for safe storage . Simply tap the button matching the tool to begin collecting evidence. Fingerprint and swab collection points will pop up in green and bag collection points show up in red. Be sure to use the correct tool as you only get one chance to collect from each point.



Photographing the Evidence

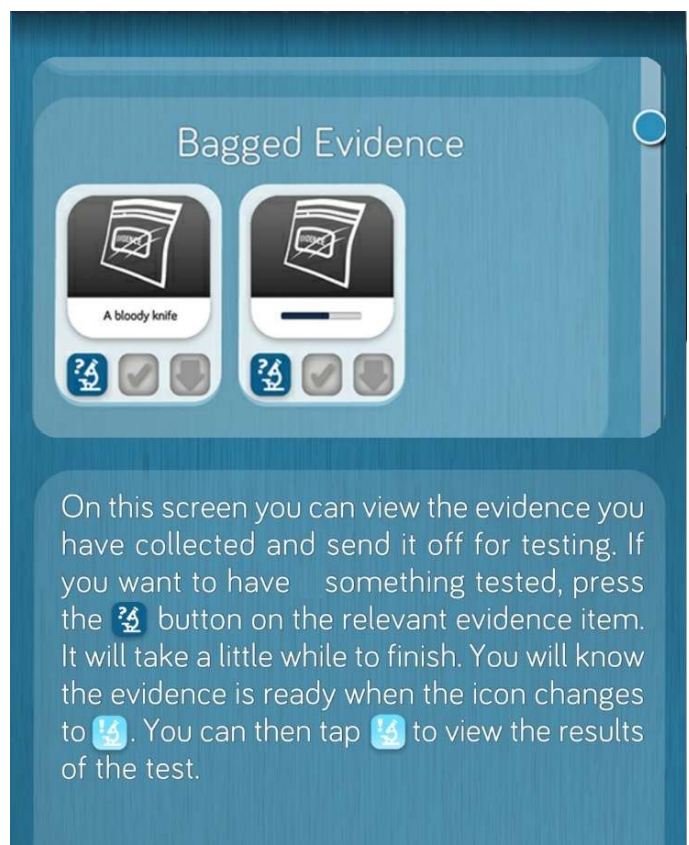

It is important to keep a record of all aspects of the crime scene. Taking a photo is the first thing you should do when approaching any aspect of a crime scene. A good photo is well centred and large on screen. You will be rewarded extra points if you take a good photo. However, if you submit a photo that has been taken after evidence has been collected from the subject of the photo, then you will be penalised. Only the most recent photo you took of each item is kept, so be sure that you are happy with this image before you start collecting evidence.

Testing the Evidence



On this screen you can view the evidence you have collected and send it off for testing. If you want to have something tested, press the  button on the relevant evidence item. It will take a little while to finish. You will know the evidence is ready when the icon changes to . You can then tap  to view the results of the test.

Choosing to include or ignore Evidence

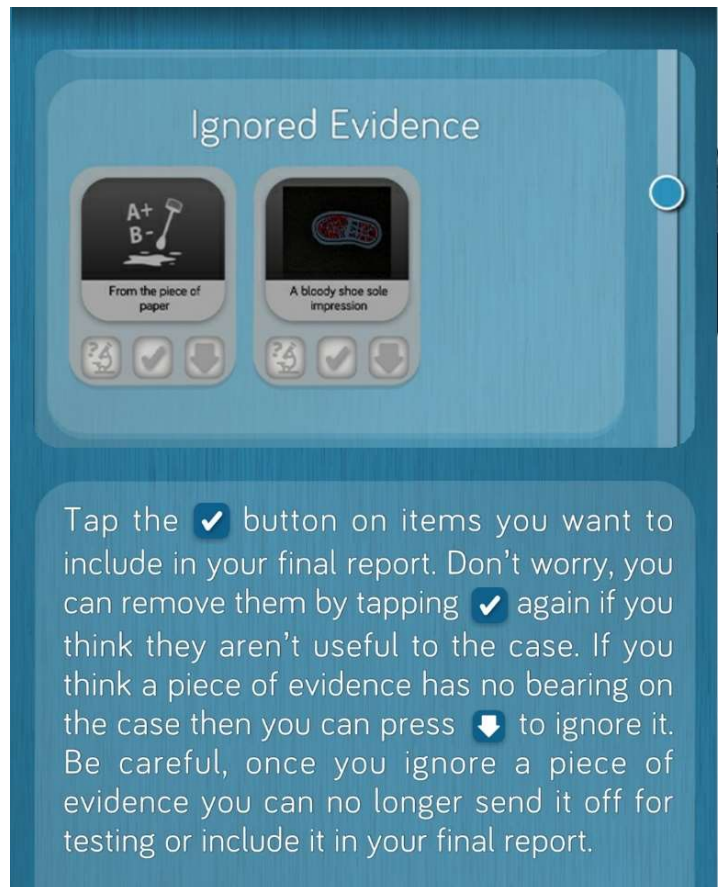

The **Facts** associated with the **Evidence** you found.

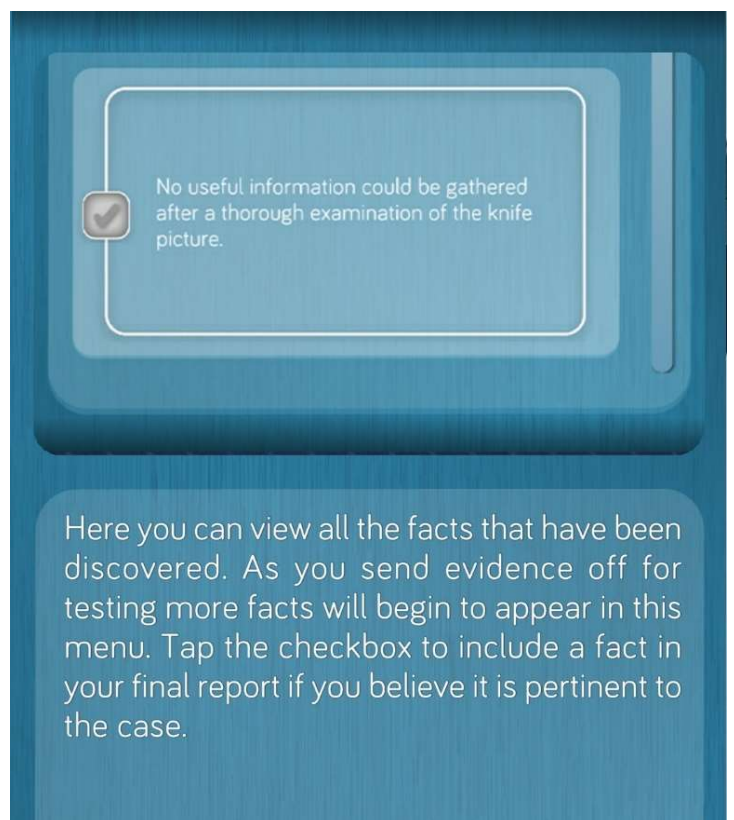

Ordering the Evidence and submitting your Final Report

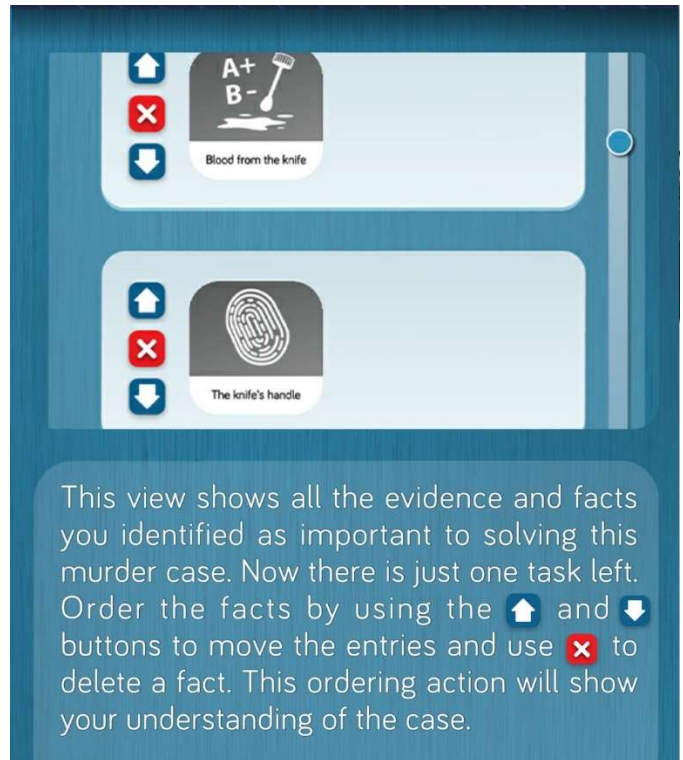

Your Final Score

The higher your score, the more likely you will pass the test and become a qualified SOCO.

000 - 150	Pay more attention and try again
151 - 300	Good job, have another go
301 - 450	Great work, concentrate on the accuracy of your Final Report
450 - 600	Excellent, you will make a great SOCO

There are 400 bonus points on offer for an accurate report.

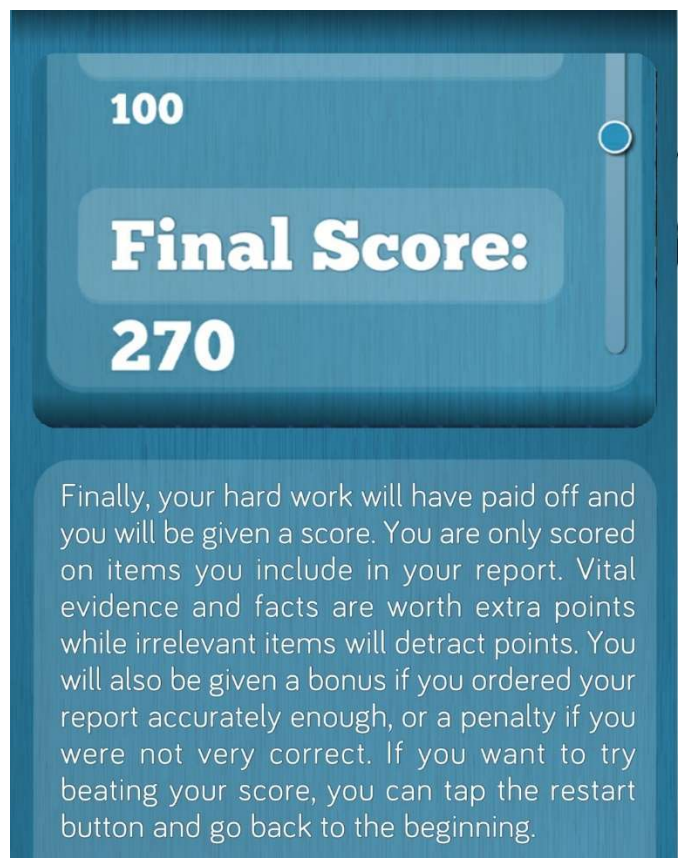

How did you do?

Would you make a good Scenes of Crime Officer?